

AC-9219-06

2024-2025 CAN-AM MAVERICK R,
AIR BOX DEFLECTOR

MBRP®

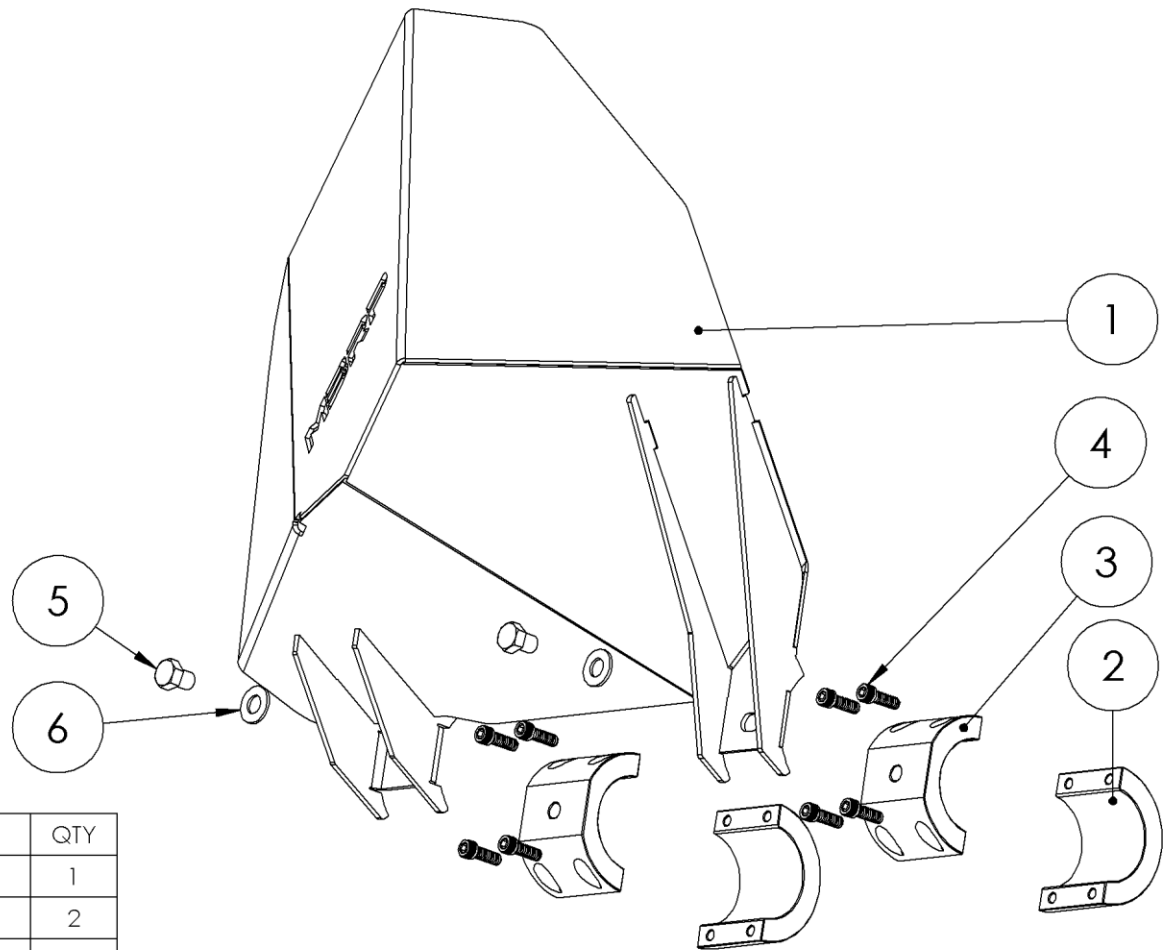

ITEM	DESCRIPTION	QTY
1	AIR BOX DEFLECTOR	1
2	LOWER CLAMP HALF	2
3	UPPER CLAMP HALF	2
4	1/4" x 3/4" SCREW	8
5	3/8"X1/2" HEX BOLT	2
6	3/8" FLAT WASHER	2

Refer to this LOT NUMBER when contacting customer service: _____

PLEASE READ BEFORE STARTING INSTALLATION

While MBRP has made every effort to ensure that all components of this kit are of superior quality and properly packaged, it is the installer's responsibility to ensure the following before installation;

- that ALL components shown above are present.
- that ALL mating components fit together.
- that there are no damaged components.
- that the product you have purchased is appropriate for your vehicle year, model and configuration.
- that the product will not interfere with any modifications previously installed or planned.
- that you have read and understand these instructions.

If you have any questions or are uncertain about any aspect of the installation of this kit to your vehicle please contact your dealer before commencing installation.

MBRP

Installation



Figure 1



Figure 2

1. Loosely assemble an **Upper Clamp Half** and a **Lower Clamp Half** using **1/4\"x3/4\" Screws** either side of the air box assembly on the chassis tube. Ensure each clamp assembly is loose enough to be moved by hand. **Refer to Figure 1.**
2. Install the **Air Box Deflector** onto the clamp assemblies using **3/8\"x1/2\" Hex Bolts** and **3/8\" Flat Washers**, adjust the clamp assembly positions as required. Rotate the **Air Box Deflector** up or down as needed to prevent contact with the bottom of the air box. **Refer to Figure 2.**
3. Tighten the **1/4\"x3/4\" Screws** that are accessible enough to prevent movement of the clamp assemblies. Remove the **Air Box Deflector** and finish tightening all **1/4\"x3/4\" Screws**. Be sure to tighten all screws evenly until the clamp halves are fully seated on the chassis tube.
4. Re-install the **Air Box Deflector**. Air filter service requires removal of the **3/8\"x1/2\" Hex Bolts**, and **Air Box Deflector**.

Congratulations! You are ready to experience the improved performance of your **MBRP** Accessory Lighting kit. We know you will enjoy your purchase!